

TECHNICAL DATA SHEET

Product: DEXTRA FORM FIXER
Revision Date: 3/15/2023

DESCRIPTION

Dextra Rolltec Form Fixer is a mechanical splice system with a Rolltec coupler and steel reinforcing bar. The Form Fixers are a dowel bar (DB) replacement, typically specified to provide continuity and structural integrity in monolithic applications for reinforced concrete construction. The DBA coupler/bar assembly is furnished with an attached square mounting plate that is nailed to a wood faced form to facilitate the positioning of reinforcement. Once the formwork is removed, the externally threaded dowel in (DI) splice bar is screwed into the exposed end of the DBA coupler/bar assembly, creating a mechanical butt splice of two sections of reinforcing steel. The Rolltec Form Fixer splice system is readily available for No. 4,5,6,7,8 steel reinforcing bars.

FEATURES

- Saves time and money
- Improves ease of concrete placement
- Eliminates drilling holes in formwork and simplifies form stripping
- Provides for efficiency in slip and jump forming
- Eliminates potential on-site safety hazards due to exposed dowels
- Maintains rebar continuity in segmental concrete construction
- Protects valuable formwork by allowing stripping, cleaning and recycling of forms in less time
- Exceeds ACI®, UBC® and IBC® Building Code Requirements

TYPICAL APPLICATIONS

New Reinforced Concrete Construction:

- Segmental Pours – positioning steel reinforcing bar within the forms of the first pour to allow mechanical rebar splicing prior to the second pour.
- Beam/Column Connection – a bent DBA coupler/bar assembly is positioned in the column to structurally join the column.
- Future Extension – embedded within the concrete to structurally join the bar at a future date.

Masonry:

- Reinforced Masonry Applications – replaces lap splices in CMU

COMPLIANCES

The DEXTRA Mechanical Splice System is used to mechanically splice deformed steel reinforcing bars (rebar) installed in concrete structural members. The splices conform to ACI 318-19 AND -14 Section 25.5.7.71 and 18.2.7 (ACI 318-11 and -08 Sections 12.14.3 and 21.1.6), for use as tension and compression mechanical splices for deformed reinforcing bar (rebar). The DEXTRA Mechanical Splice

System complies with both Type 1 and Type 2 mechanical splice requirements in accordance with ACI 318-19 and -14 Section 18.2.7.1 (ACI 318-11 and -08 Section 21.1.6.1).

MATERIAL

The Form Fixer mechanical splice system consists of a Rolltec coupler with a steel square mounting plate attached to one end of the coupler. The Couplers are manufactured from steel complying with GB/T699 or GB/T8162 grade 45, with a minimum specified yield and tensile strengths of 45 and 85 ksi (315 and 590 MPa) respectively. The ends of the steel reinforcing splice bars are threaded with metric threads to mate with the internal threads of the coupler. The steel reinforcing splice bar complies with ASTM A615 grade 60 or ASTM A706 grade 60 for No 4,5,6,7,8.

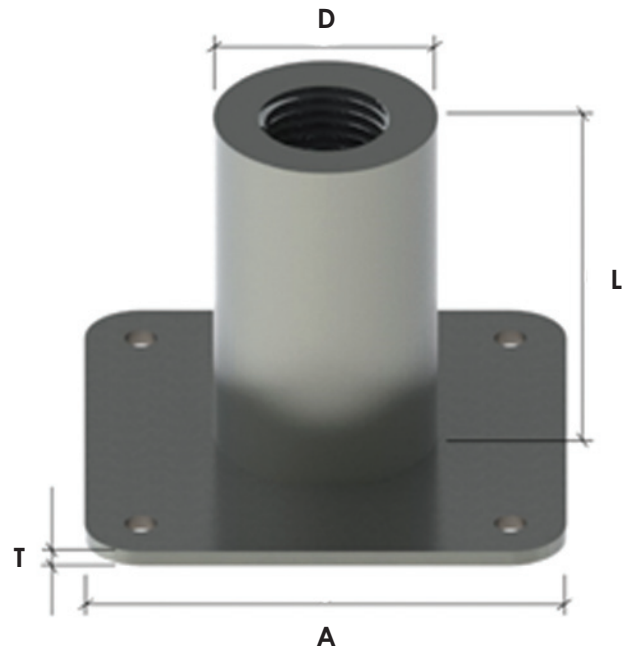

Bar Size	Model	Plastic Cap Color	Approximate external dimensions (inches)			
			A	D	L	T
#4	DBA4	Black	2-3/8"	3/4"	1-1/2"	14ga
#5	DBA5	Blue	2-3/8"	1"	1-7/8"	14ga
#6	DBA6	Lavender	2-3/8"	1-1/4"	2-5/16"	14ga
#7	DBA7	Grey	2-3/8"	1-5/16"	2-1/2"	14ga
#8	DBA8	Light Blue	2-3/8"	1-9/16"	2-11/16"	14ga

DEXTRA FORM FIXER | technical datasheet

DEXTRA FORM FIXER SPLICE PERFORMANCE				
Bar Size	Nominal Area (inch ²)	Grade 60 Rebar Yield Strength (lbs)	Type I 125% Yield Strength (lbs)	Type II 90 KSI Tensile Strength (lbs)
#4	0.20	12,000	15,000	18,000
#5	0.31	18,600	23,250	27,900
#6	0.44	26,400	33,000	39,600
#7	0.60	36,000	45,000	54,000
#8	0.79	47,400	59,250	71,100

INSTALLATION

To assemble the Rolltec Form Fixer DBA coupler/bar, thread the end of the DI splice bar onto the DB coupler. Hand tighten to fully engage the threads (a pipe wrench may be used). The depth of the thread engagement is limited by the threads on the DI splice bar and is one-half the DB coupler length. The mounting plate of the coupler is then attached to the face of the formwork. After the forms are stripped remove the plastic caps from the form fixer. The DI splice bar is threaded into the opposite end of the DBA coupler/bar assembly and the splice is tightened with a pipe wrench applied to the DI splice bar. The final installation of the Rolltec splice system shall not have more than 2 bar end threads visible from each end of the coupler.

DBA and DI Minimum Bend Length "A"		
Bar Size	DBA coupler/bar assembly (inches)	DI splice bar (inches)
#4	5-1/4"	4-1/2"
#5	7-1/4"	6-1/4"
#6	7-3/4"	6-1/2"
#7	8-1/2"	7-1/4"
#8	10"	9"

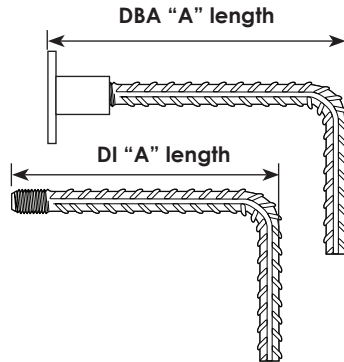

MASONS SUPPLY COMPANY
 2637 SE 12th Ave.
 Portland, OR 97202
 (503)234-4321, FAX (503)234-5606
 www.masco.net

DISCLAIMER OF WARRANTIES AND LIMITATIONS OF LIABILITY

MASONS SUPPLY CO. (Seller) warrants that if any goods supplied prove defective in workmanship or material, that Seller shall replace them or refund their purchase price. THIS WARRANTY IS MADE IN LIEU OF ANY AND ALL OTHER WARRANTIES, EXPRESSED OR IMPLIED, INCLUDING THE WARRANTIES OF MERCHANTABILITY AND/OR FITNESS WHICH ARE HEREBY DISCLAIMED. IT IS UNDERSTOOD AND AGREED THAT BUYER'S SOLE REMEDY, AND THEREFORE SELLER'S LIABILITY, WHETHER IN CONTRACT, TORT, UNDER ANY WARRANTY, IN NEGLIGENCE, OR OTHERWISE SHALL BE LIMITED TO THE RETURN OF THE PURCHASE PRICE PAID BY PURCHASER OR REPLACEMENT OF ANY DEFECTIVE GOOD'S SOLD BY SELLER AND UNDER NO CIRCUMSTANCES SHALL SELLER BE LIABLE FOR SPECIAL, INDIRECT OR CONSEQUENTIAL DAMAGES. THE PRICE STATED FOR THE GOODS IS A CONSIDERATION IN LIMITING SELLER'S LIABILITY. Before application, the User shall determine the suitability of the product for his intended use and User assumes all risks and liabilities whatsoever in connection therewith. The terms of this paragraph may not be orally modified. THERE ARE NO WARRANTIES WHICH EXTEND BEYOND THE FACE HEREOF.

DBA coupler/bar assembly

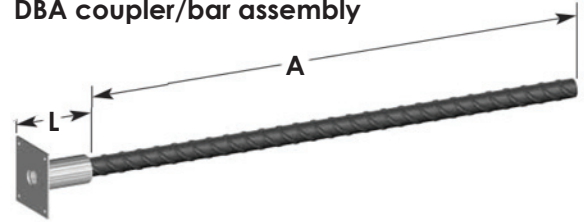

FORM FIXER DBA COUPLER/BAR ASSEMBLY			
Type I Item Number	Rebar Size	"A" Length (inches)	"L" Length (inches)
DEX DBA424	#4	24"	1-1/2"
DEX DBA430	#4	30"	1-1/2"
DEX DBA436	#4	36"	1-1/2"
DEX DBA448	#4	48"	1-1/2"
DEX DBA524	#5	24"	1-7/8"
DEX DBA530	#5	30"	1-7/8"
DEX DBA536	#5	36"	1-7/8"
DEX DBA548	#5	48"	1-7/8"
DEX DBA630	#6	30"	2-5/16"
DEX DBA636	#6	36"	2-5/16"
DEX DBA648	#6	48"	2-5/16"
DEX DBA760	#7	60"	2-1/2"
DEX DBA860	#8	60"	2-11/16"

Additional lengths are available upon request.

DI splice bar

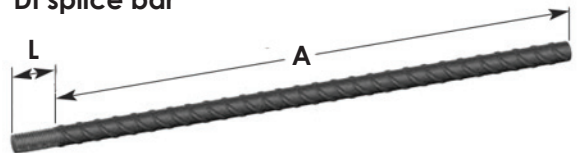

FORM FIXER DI SPLICE BAR			
Type I Item Number	Rebar Size	"A" Length (inches)	"L" Length (inches)
DEX DI424	#4	24"	3/4"
DEX DI430	#4	30"	3/4"
DEX DI436	#4	36"	3/4"
DEX DI448	#4	48"	3/4"
DEX DI524	#5	24"	1"
DEX DI530	#5	30"	1"
DEX DI536	#5	36"	1"
DEX DI548	#5	48"	1"
DEX DI630	#6	30"	1-1/8"
DEX DI636	#6	36"	1-1/8"
DEX DI648	#6	48"	1-1/8"
DEX DI760	#7	60"	1-1/4"
DEX DI860	#8	60"	1-3/8"

Additional lengths are available upon request.